

Thank you very much for purchasing this product.  
Please read this user's manual carefully before using the product.  
There is a guarantee certificate at the end of this document,  
so please make sure to store it in a safe place.

## Warning

### 警告

- Do not use this product while driving or riding a vehicle.
- Make sure to use the right voltage, AC adapter, etc. by following the specifications in this document.
- Do not use this product if you find any problems with it, including any damages, faults, deformities, broken cables, etc.
- If you notice any smoke, offensive smell, abnormal heat, etc. coming from the product, turn the power off and stop using it immediately.
- Do not pull on the cable or touch the plug area with wet hands.
- Do not leave or use this product or the power adapter in places that may be subject to high temperatures, such as stoves, etc.
- Avoid using this product with wet hands, or when it is damp or covered in dirt, etc.
- Except for Water Tant, this product is not waterproof. Never use this product in places with high humidity, such as bathrooms, etc. This may cause burns, electric shocks, or product faults.
- If you notice any abnormal effect on your skin, stop using this product and consult your physician.
- Look at the list below carefully, and do not use this product if any of those conditions apply to you.

### 注意

- Do not cover the Mist Port with your finger or something.
- You can use only WATER. Do not use any beauty thick liquid, lotion and serum.
- Do not subject the product to any strong actions such as by dropping or hitting it.
- Do not wash this product with water. If dirty, take a damp cloth, wring it well, and use it to clean the product gently. Do not use solvents such as benzene, thinners, etc. to clean this product.
- Any injuries, faults, damages, etc. caused to the product due to your failure to follow the important notes and warnings stated above, any incorrect use or disassembly/reassembly of the product, or any maintenance work done by yourself, are not covered by the product guarantee, and the company shall bear no responsibility for them.

## Specific

※There may be some changes without any notice.

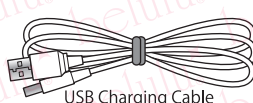
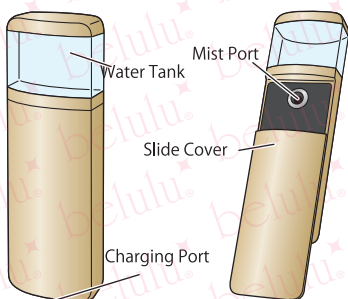

Size:  
H123×W40×D23.5mm  
Weight: 76g Water Tank: 16ml  
350mAh/5V

-1-

## Charging

- Before using please be sure to charge.
- Please be sure to screw the Water Tank and the Unit firmly. And close the Slide Cover.
- Please connect the USB cable to outlet with adapter, personal computer or mobile battery.
- While charging, it turns on red light.
- ※ The device may become slightly hotter while charging; however, this is normal.
- The charging time and operating time will vary depending on how frequently the product is used.
- The charging light goes off when the product is fully charged. Make sure to disconnect the cable once charging is complete.
- This product cannot be used while connected to the charging cable. Make sure to check that the charging cable is disconnected when using the product.
- The most suitable room temperature for charging is 15°C to 30°C. Charging the product at low temperatures may shorten its battery life, so make sure to charge the product at the appropriate temperature. In addition, the product's charging speed may decrease at approximately 0°C or less.
- In order to protect the built-in battery, make sure to charge the product once per month even when you are not using it for long periods of time.

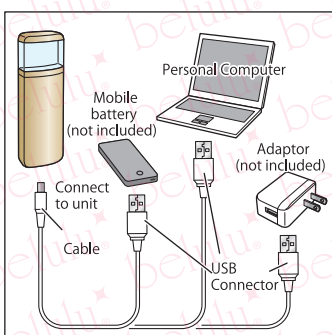

## Refilling

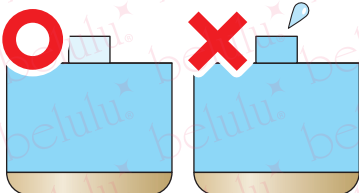
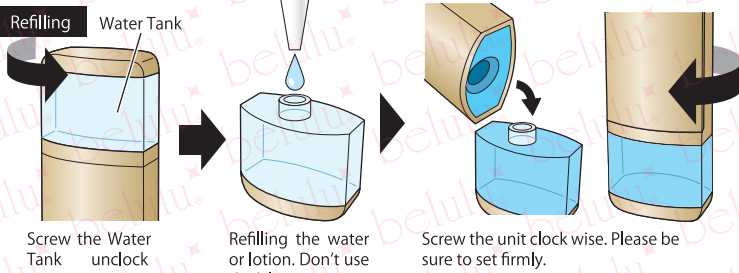

Caution!

Fill the water 80% of Tank!!

-2-

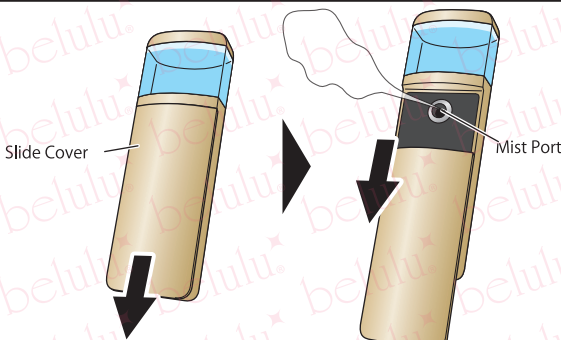

When you slide down the Slide Cover, it turns on automatically.  
Then Mist will blow out from Mist Port.  
The machine turns off after 1 minute automatically.

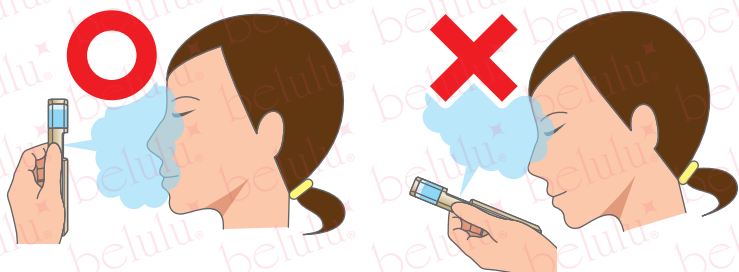

If you think the mist is not coming out well, please follow the steps below.



※ Depending on the type of lotion, it cannot be spouted.  
Please use a smooth type lotion.  
When replacing the lotion, follow steps ① to ③ above.

-3-

- Don't use the beauty thick liquid, oil, cream and serum. It cause some troubles.
- When you bring this products, please remove all water in the tank. It cause leaking.
- Please exchange the water in the tank each time to keep clean.
- Don't cover the Mist Port with your finger or something.
- Clean the Mist Port frequently to remove the water lump.
- If you find any problems on the machine or skin, stop using.

## After Use

- Please apply any cream or serum to your skin.
- Please clean the Mist Port.
- Please remove the water in the tank, and clean it.
- Close the Slide Cover when you store it.
- Avoid storing in places with high temperatures, high humidity, or under direct sunlight, as well as places that are highly dusty or within the reach of children.

【Warranty】 ※Only for the main device only

■ No.:                      ■ Name: belulu MoisMist  
■ Within 1 year from your date of purchase  
■ Your name: \_\_\_\_\_  
■ Address: \_\_\_\_\_  
■ Order #: \_\_\_\_\_

Beautiful Angel Co., Ltd.  
Order date: \_\_\_\_\_

- When purchasing by mail order, it does not matter if this document does not include the purchase date or store stamp, as customers' information and purchase histories are generally managed by the store. However, your order number will be required when making an inquiry or requesting a repair, so please make sure to make a note of your order number in a safe place.
- This guarantee certificate constitutes our promise to make repairs based on the conditions and the guarantee period specified in this document. Therefore, for the main device only, this guarantee certificate does not affect customers' statutory rights. Please contact us if you have any queries

- Regardless of the number of times that the product has been used, if a repair request is made 3 months after the date of purchase, the customer shall be liable for the return postage fee.
- Outside of the guarantee period, if after diagnosis we consider that repairing the product would be feasible, you may request for such a repair to be executed subject to a repair fee.

We accept a refund only for defective within 7 days.

Please feel free to contact us.

TEL: +81-45-227-5121

E-mail: shop@kireido.com

ZIP: 221-0801

Add: Beautiful Angel Co., Ltd

Kentai building Kandaiji

2-29-25, Kanagawa-ku

Yokohama Kanagawa

Japan